

11/14/23

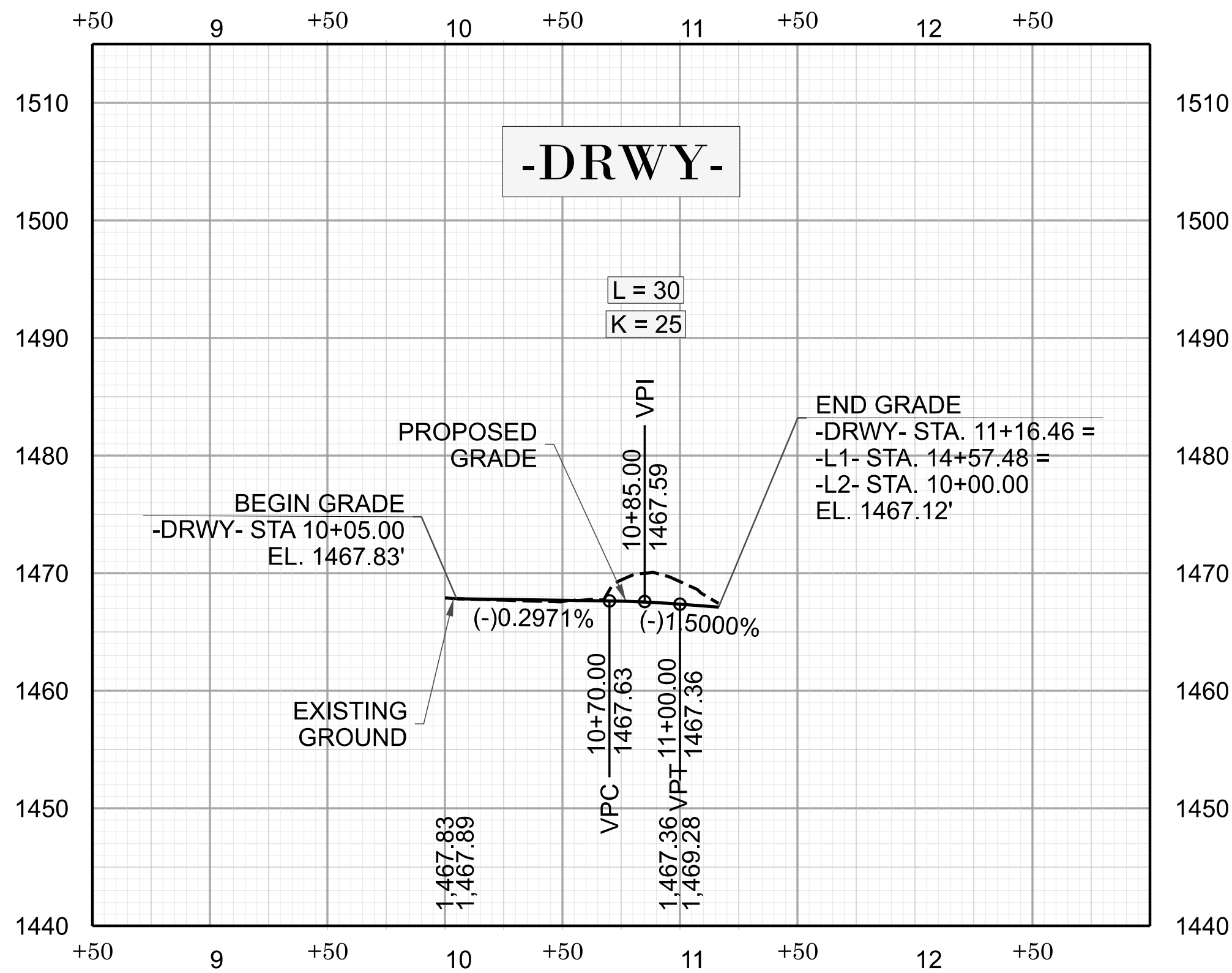
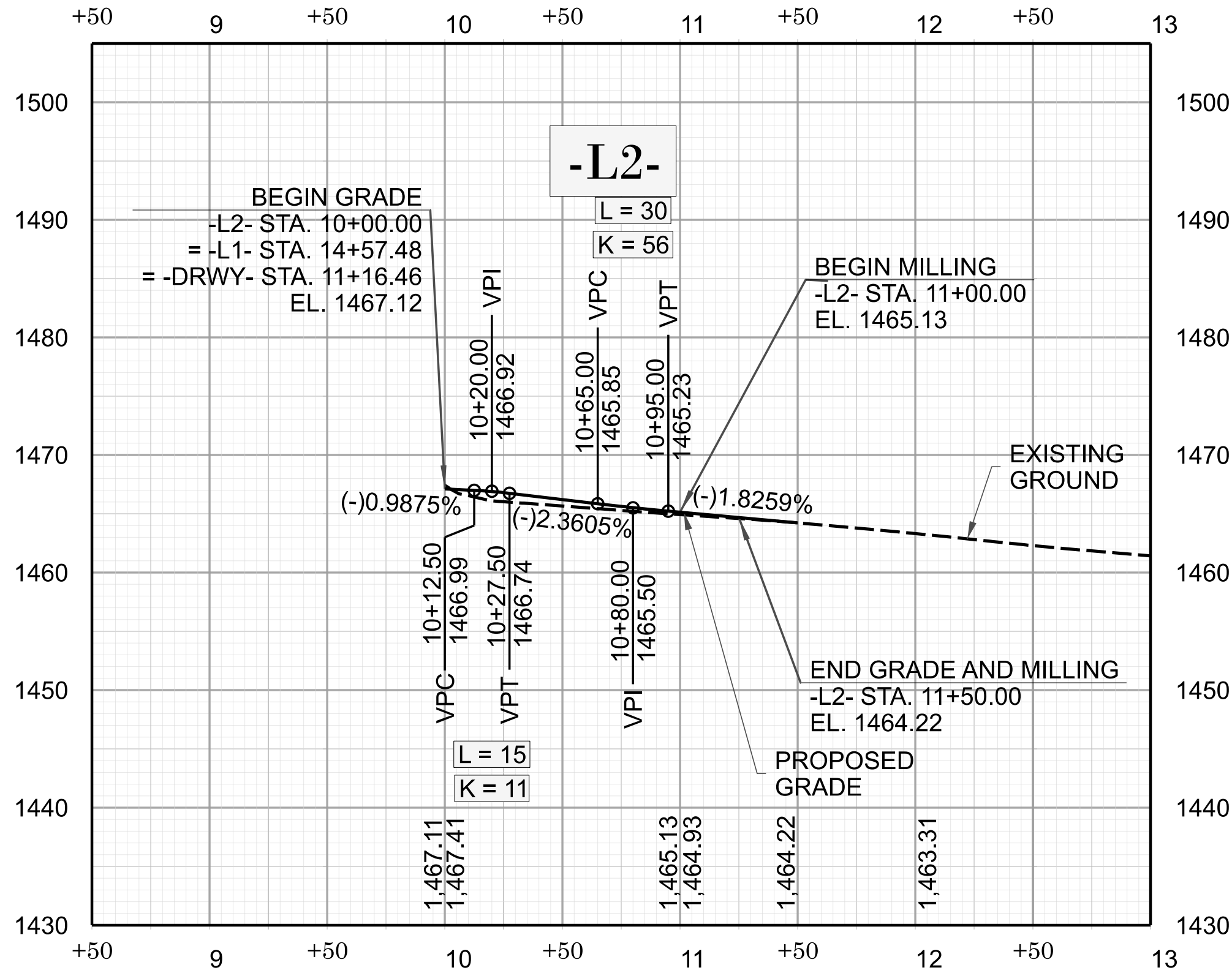
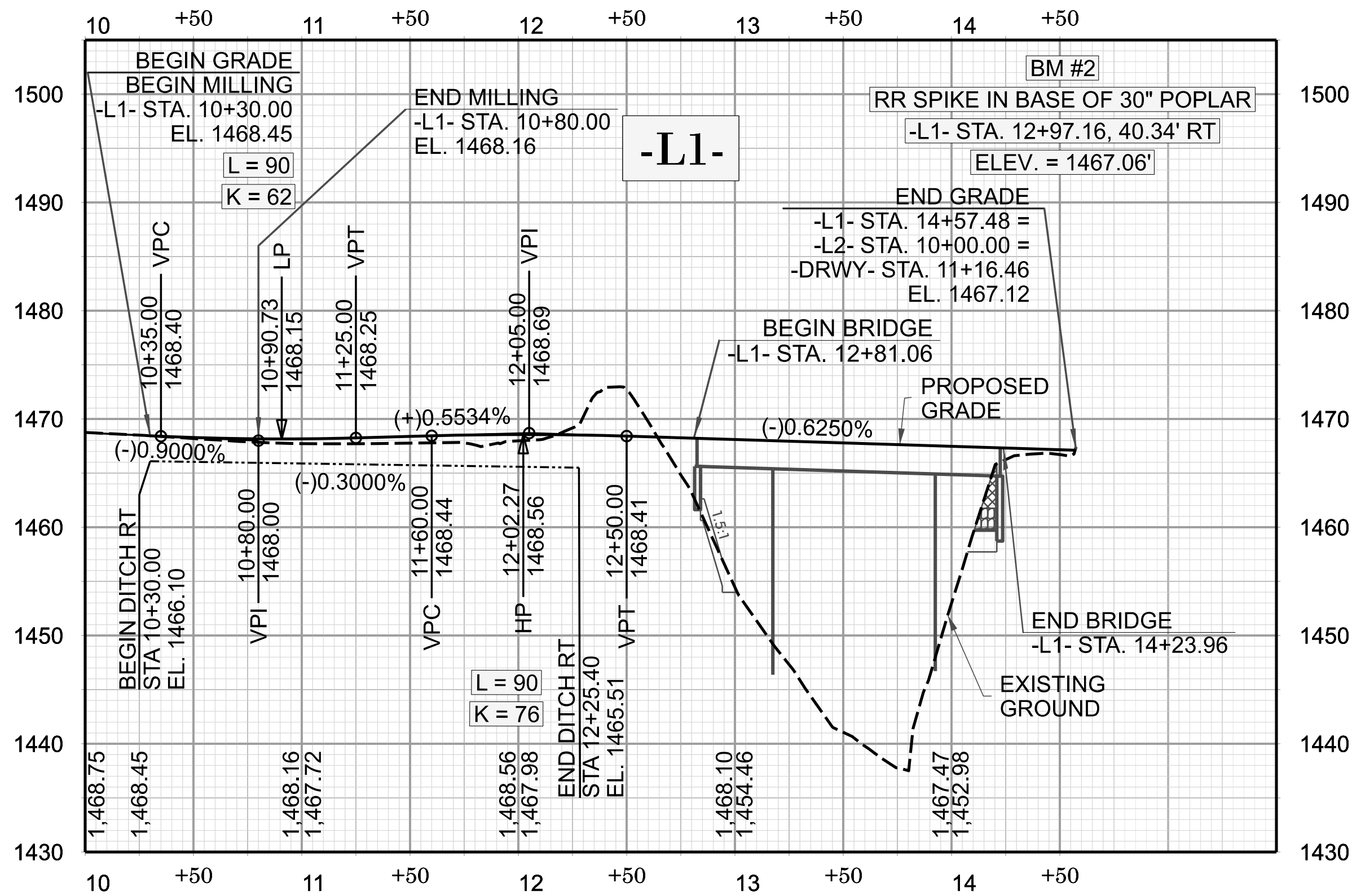

BRIDGE HYDRAULIC DATA

DESIGN DISCHARGE	=	2300 CFS
DESIGN FREQUENCY	=	25 YRS
DESIGN HW ELEVATION	=	1449.4 FT
BASE DISCHARGE	=	3460 CFS
BASE FREQUENCY	=	100 YRS
BASE HW ELEVATION	=	1450.9 FT
OVERTOPPING DISCHARGE	=	16000 CFS
OVERTOPPING FREQUENCY	=	500+ YR
OVERTOPPING ELEVATION	=	1466.8 FT

W.S.ELEVATION ON DATE
OF SURVEY(7/31/24) = 76133 FT

SEE SHEET 4 FOR PLAN VIEW OF ALL ALIGNMENTS

BPI4-R038

4R01 05

NORTH CAROLINA
DEPARTMENT OF TRANSPORTATION
POLK COUNTY



ROADWAY DESIGN UNIT
ENGINEER



11/4/2025
Shad Duncanson
1E108BETTER

11/5/2025
Eric Burger
1E108BETTER

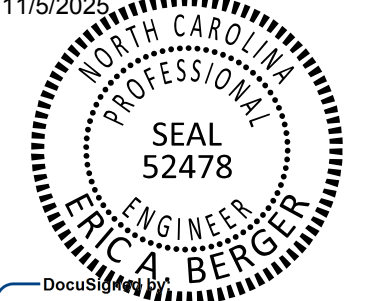

11/5/2025
Eric Burger
1E108BETTER



DOCUMENT NOT CONSIDERED FINAL
UNLESS ALL SIGNATURES COMPLETED